

REV.	DESCRIPTION	DRAWN	CHECKED	APPROVED
A	NEW RELEASE	YCH 06/12/08'	~	

NOTES:

- PRODUCTS PERFORMANCE:
 - VOLTAGE RATING: 250V AC.
 - CURRENT RATING: 1.5A MAX.
 - CONTACT RESISTANCE: 20mΩ MAX.
 - DIELECTRIC WITHSTANDING VOLTAGE: 500V AC(rms) FOR 1 MINUTE.
 - INSULATION RESISTANCE: 1000MΩ MINI.
 - OPERATING TEMPERATURE: -20°C~+70°C.
- PRODUCT NUMBER CODE:

DS1038-01 - X X X X X X X X

- SCREW DIM. G
- 4: 4.80mm
- 5: 5.80mm
- BOARD LOCK DIM. F
- 7: 3.70mm
- SCREW TYPE
- A: WITH SCREW TYPE
- B: WITH RIVET TYPE
- C: WITH SCREW AND RIVET TYPE
- CONTACT PLATING
- Si: SELECTIVE GOLD FLASH
- B: FULL GOLD FLASH
- 6: FULL TIN
- SHELL PLATING
- N: Nickel
- T: Tin
- COLOR OF HOUSING
- B: BLACK
- U: BLUE
- C: BLUE(PC99)
- CONNECTOR TYPE
- M: MALE
- F: FEMALE
- No. OF CONTACT
- 15: 15pos.

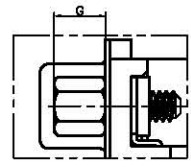

WITH SCREW AND RIVET TYPE

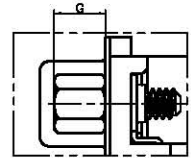

WITH SCREW TYPE

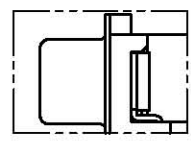

WITH RIVET TYPE

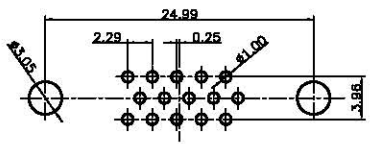
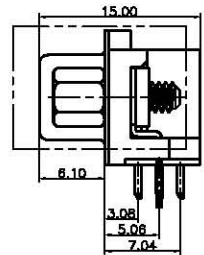
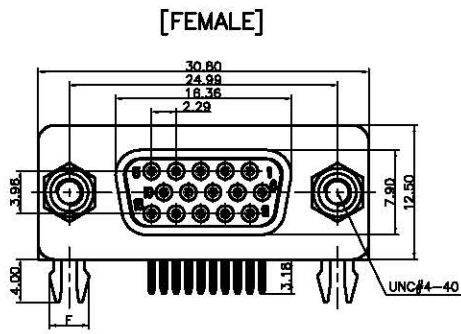

RECOMMEND PCB LAYOUT (TOLERANCE ±0.05)

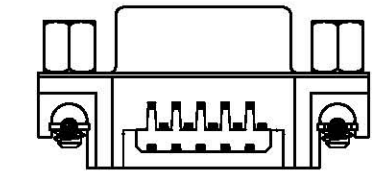

[MALE]

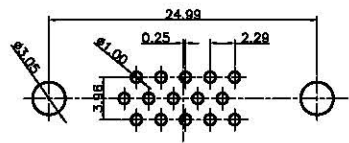
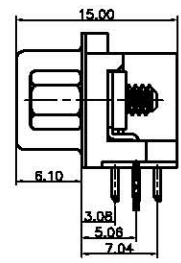
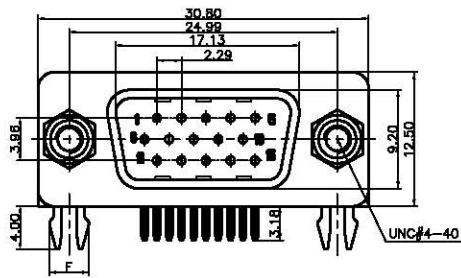

RECOMMEND PCB LAYOUT (TOLERANCE ±0.05)

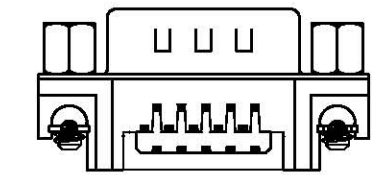

GENERAL TOLERANCE		ANGLE TOLERANCE	
X.	±0.60	X.	±5°
.X	±0.50	.X	±3°
.XX	±0.30	.XX	±2°

DRAWING TYPE	CUSTOMER		
SCALE	1:1	SHEET	1 OF 1
DRAWING NO.	C-DS1038-01-XXXXXXXX		

PROJECTION	TITLE
UNITS	D-SUB H.D RIGHT ANGLE 3.08mm TYPE
SHEET SIZE	A4
SERIES	DS1038-01 SERIES

广东中南电子电器有限公司

www.zn-cn.com