

REV.	DESCRIPTION	DRAWN	CHECKED	APPROVED
A	NEW RELEASE	LJH 05/24/05'		

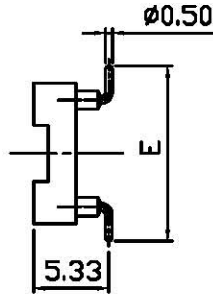
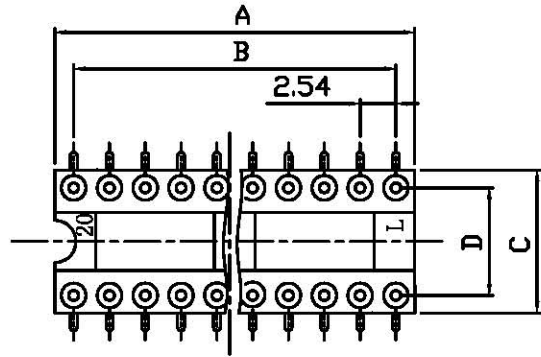

NOTES:

- ELECTRICAL CHARACTERISTICS:
 - CONTACT RESISTANCE: 20mΩ Max. INITIAL.
 - DIELECTRIC WITHSTANDING VOLTAGE: 500V AC(rms) FOR 1 MINUTE.
 - INSULATION RESISTANCE: 1000MΩ Min.
- ENVIRONMENT CHARACTERISTICS:
 - OPERATING TEMPERATURE: 0°C~+85°C.
 - STORAGE TEMPERATURE: -20°C~+70°C.

3. PART NUMBER: DS1001-02

4. PRODUCT NUMBER CODE:

DS1001-02 - X X X X

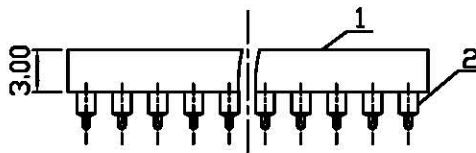

Position	Dimension				
	A±0.5	B±0.2	C	D±0.1	E±0.3
06	7.60	5.08	10.14	7.62	12.42
08	10.16	7.62	10.16	7.62	12.42
14	17.16	15.24	10.16	7.62	12.42
16	20.32	17.78	10.16	7.62	12.42
18	22.86	20.32	10.16	7.62	12.42
20	25.40	22.86	10.16	7.62	12.42
24	30.48	27.94	10.16	7.62	12.42
28	35.56	33.02	10.16	7.62	12.42
24	30.48	27.94	17.78	15.24	20.04
28	35.56	33.02	17.78	15.24	20.04
32	40.62	38.10	17.78	15.24	20.04
40	51.00	48.26	17.78	15.24	20.04

Clip plating

1: Tin 150u"

2: Tin 200u"

3: G/F

4: Gold 3u"

5: Gold 10u"

6: Gold 15u"

Pin plating

1: Tin 150u"

2: Tin 200u"

3: G/F

4: Gold 3u"

5: Gold 10u"

6: Gold 15u"

Width

N: 7.62mm

W: 15.24mm

No. of contacts

06 08 14 16 18 20 24

28 32 40

GENERAL TOLERANCE		ANGLE TOLERANCE	
X.	±0.60	X.	±5°
.X	±0.38	.X	±3°
.XX	±0.25	.XX	±2°

PROJECTION	TITLE
UNITS	SMT IC SOCKET PITCH 2.54mm(0.100")
SHEET SIZE	SERIES DS1001-02 SERIES

2	CONTACT	COPPER ALLOY	GOLD PLATED	DRAWING TYPE	CUSTOMER
1	HOUSING	THERMOPLASTIC	UL 94 V-0	SCALE	1:1 SHEET 1 OF 1
ITEM	PART NAME	PART NO.	MATERILAS	FINISHED	DRAWING NO. C-DS1001-02-XXXXX

广东中南电子电器有限公司

www.zn-cn.com