

REV.	DESCRIPTION	DRAWN	CHECKED	APPROVED
A	NEW RELEASE	YCH 03/15/08'	~	

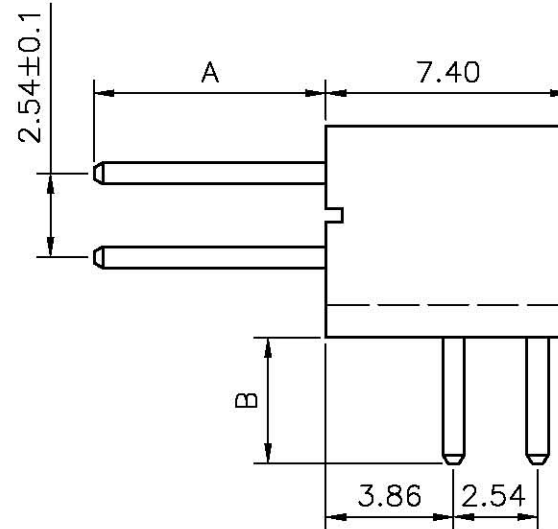
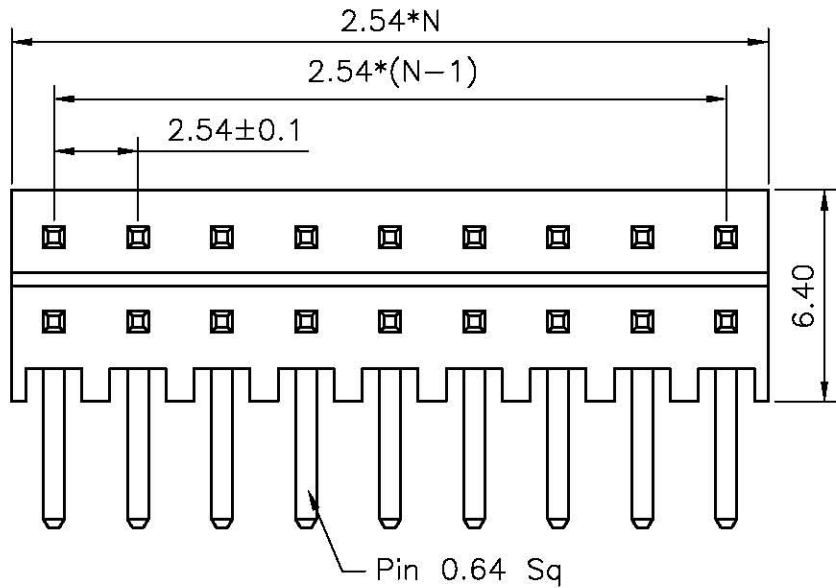

NOTES:

- MATERIAL
 - INSULATOR:
 - DIP TYPE: PBT G.F30% UL 94-V0
 - SMT TYPE: PA-46 G.F30% UL 94-V0
 - CONTACT: COPPER ALLOY.
- SPECIFICATION
 - TEMPERATURE RANGE: -45 TO 110°C.
 - CONTACT RESISTANCE: 20mΩ max.
 - INSULATION RESISTANCE: 1000MΩ min.
 - DIELECTRIC WITHSTANDING VOLTAGE: AC 500V PER MINUTE.

3. PRODUCT NUMBER CODE:

DS1022-09- X X X X

Dim. A B type
1: Type 1

CONTACT PLATING
8: FULL GOLD FLASH
6: FULL TIN

MOUNTING TYPE
R: RIGHT ANGLE

No. OF CONTACTS
2*2 - 2*40

TABLE A:

TYPE	Dimension	
	A	B
1	7.00	3.80
2	6.00	3.00
3		
4		
5		
6		
7		
8		
9		

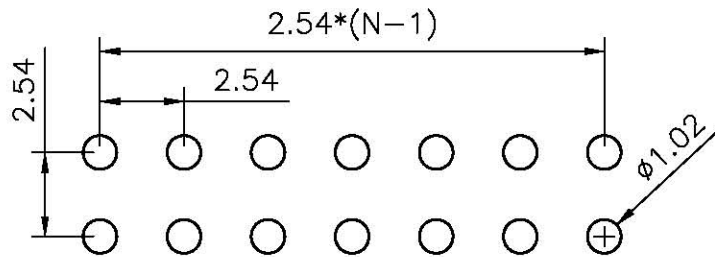

RECOMMEND PCB LAYOUT
(TOLERANCE=±0.05)

GENERAL TOLERANCE		ANGLE TOLERANCE		PROJECTION	TITLE
X.	±0.60	X.	±5°		2.54mm PIN HEADER
.X	±0.38	.X	±3°	mm	RIGHT ANGLE TYPE H=7.4mm
.XX	±0.25	.XX	±2°	A4	SHEET SIZE
DRAWING TYPE				CUSTOMER	SERIES
SCALE				1:1	DS1022-09 SERIES
DRAWING NO.				C-DS1022-09-2*XXXX	