

REV.	DESCRIPTION	DRAWN	CHECKED	APPROVED
A	NEW RELEASE	LJH 06/22/05'		

NOTES:

- MATERIAL
 - INSULATOR:PA-46(UL 94V-0).
 - CONTACT MATERIAL:COPPER ALLOY.
- SPECIFICATION
 - CURRENT RATING:1.0 Amp.
 - INSULATION RESISTANCE:1000MΩ Min.
 - DIELECTRIC WITHSTANDING:300VAC.
 - CONTACT RESISTANCE:50mΩ Max.
 - OPERATING TEMPERATURE:-40°C TO+105°C.

3. PART NUMBER: DS1031-11

4. PRODUCT NUMBER CODE:

DS1031-11 - X X X X X X X

- DIM.A B C TYPE
- 1: TYPE 1
- HOUSING HEIGHT(DIM.D)
- 1: 1.00mm
- 2: 1.50mm
- 3: 1.70mm
- 4: 2.00mm
- MOUNTING TYPE
- V:VERTICAL TYPE
- HOUSING COLOR
- B:BLACK
- CONTACT PLATING
- 8: FULL GOLD FLASH
- CONNECTOR TYPE
- P:PLUG
- No.OF CONTACTS
- 2*1-2*40
- SERIES No.
- DS1031-11

TYPE	DIM A	DIM B	DIM C
1	3.00	2.30	6.00
2	4.00	3.00	15.00
3			
4			
5			
6			
7			
8			
9			
10			
11			

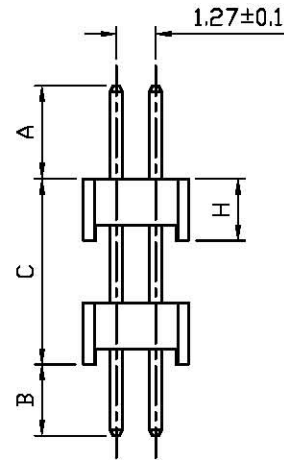
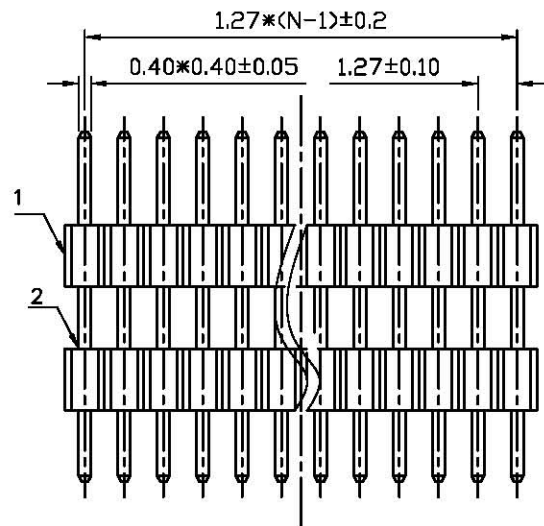
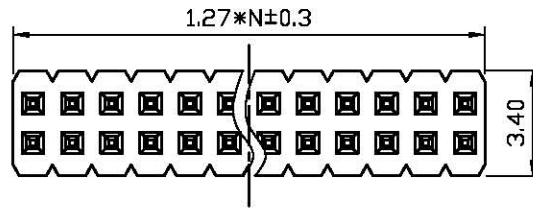

N:HALF OF CONTACTS

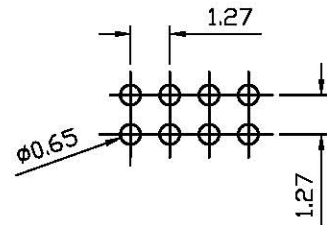

RECOMMEND PCB LAYOUT(TOLERANCE=±0.05)

GENERAL TOLERANCE		ANGLE TOLERANCE	
X	±0.60	X	±5'
.X	±0.38	.X	±3'
.XX	±0.25	.XX	±2'

PROJECTION	TITLE
UNITS	DUAL ROW PIN HEADER PITCH 1.27mm
SHEET SIZE	SERIES DS1031-11 SERIES

2	CONTACT	COPPER ALLOY	GOLD FLASH	DRAWING TYPE	CUSTOMER
1	HOUSING	THERMOPLASTIC	UL 94 V-0	SCALE	1:1 SHEET 1 OF 1
ITEM	PART NAME	PART NO.	MATERILAS	FINISHED	DRAWING NO. C-DS1031-11-XXXXXXX