

REV.	DESCRIPTION	DRAWN	CHECKED	APPROVED
A	NEW RELEASE	YCH 03/24/09	~	

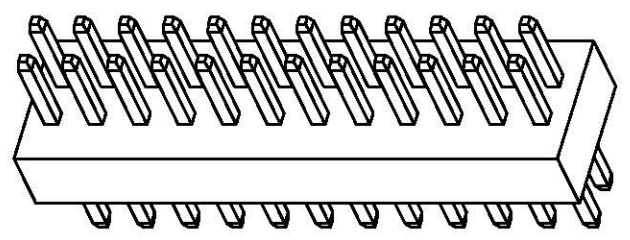
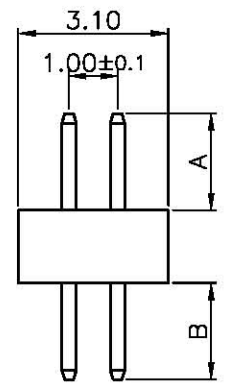
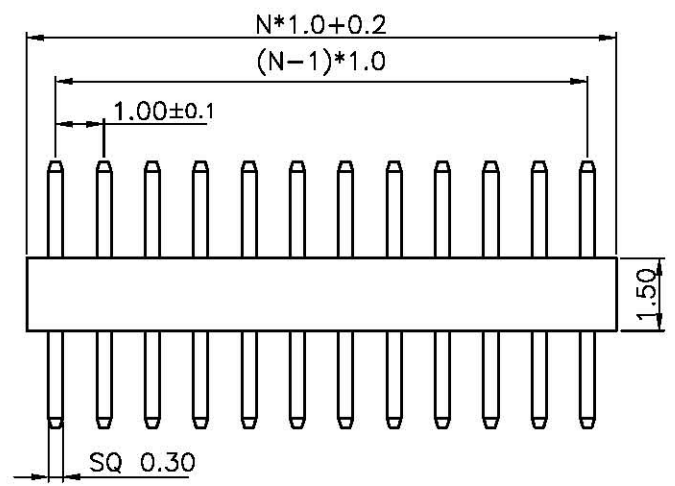

TYPE	DIM A	DIM B
1	2.00	2.00
2		
3		
4		
5		
6		
7		
8		
9		
10		

NOTES:

- MATERIAL
 - INSULATOR: PA-46(UL 94V-0).
 - CONTACT MATERIAL: COPPER ALLOY.
- SPECIFICATION
 - CURRENT RATING: 1.0 Amp.
 - INSULATION RESISTANCE: 500MΩ Min.
 - DIELECTRIC WITHSTANDING: 600VAC.
 - CONTACT RESISTANCE: 20mΩ Max.
 - OPERATING TEMPERATURE: -45°C TO +110°C.
- PART NUMBER: DS1031-25
- PRODUCT NUMBER CODE:
 DS1031-25 - X X X X X X
 DIM.A B TYPE
 1: TYPE 1
 MOUNTING TYPE
 V: VERTICAL TYPE
 HOUSING COLOR
 B: BLACK
 CONTACT PLATING
 8: FULL GOLD FLASH
 CONNECTOR TYPE
 P: PLUG
 No.OF CONTACTS
 2*2-2*40

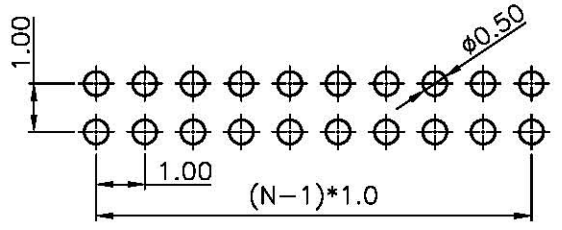

GENERAL TOLERANCE		ANGLE TOLERANCE		PROJECTION	TITLE
X.	± 0.60	X.	$\pm 5^\circ$		DUAL ROW PIN HEADER
.X	± 0.38	.X	$\pm 3^\circ$	mm	PITCH 1.0mm V/T TYPE
.XX	± 0.25	.XX	$\pm 2^\circ$	A4	SERIES DS1031-25 SERIES
DRAWING TYPE		CUSTOMER			
SCALE	1:1	SHEET	1 OF 1		
DRAWING NO.	C-DS1031-25-XXXXXX				